

#### NOTES:

##### 1. MATERIALS:

##### CORDETTE SWITCH:

HOUSING - THERMOPLASTIC, WHITE  
 BUTTON - THERMOPLASTIC, BLACK  
 CONTACTS - COPPER ALLOY, GOLD PLATED  
 OVERMOLD - THERMOPLASTIC, GRAY

##### RCA JACK:

HOUSING - STEEL, BRIGHT NICKEL  
 RECEPTACLE - COPPER ALLOY, MATTE TIN  
 INSULATORS - PHENOLIC & THERMOPLASTIC

##### 2. THIS PRODUCT IS RoHS COMPLIANT.

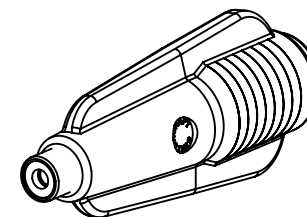
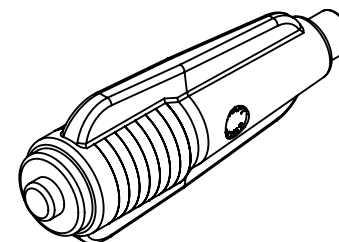

**CUSTOMER DRAWING**

					<div>UNLESS OTHERWISE SPECIFIED</div> <div>1. ALL DIMENSIONS IN INCHES</div> <div>- TWO PLACE DECIMALS     ±0.02</div> <div>- THREE PLACE DECIMALS   ±0.005</div>	THIS DRAWING DESCRIBES A DESIGN CONSIDERED PROPRIETARY IN NATURE, DEVELOPED AND MANUFACTURED BY SWITCHCRAFT INC. AND IS RELEASED ON A CONFIDENTIAL BASIS FOR IDENTIFICATION PURPOSES ONLY.						
						SIZE	WIDTH		MULT	LBS/M	TEMPER	
						FINISH				MATERIAL		
						SPEC No.				SPEC No.		
						FIRST USED ON			SCALE		Switchcraft®	
									1:1			
						DATE DRAWN	BY	CHKD	APVD			
A	26210	1-17-07	TO	TJK	08-29-11	JEB	JEB	TJK		SHEET    1                      OF    1		
							08-29-11	11-10-15				
REV	ECO NUMBER	DATE	BY	APVD	NAME    ST-900 CORDETTE SWITCH TO ST-60 RCA JACK, RoHS					PART No.		REV
REVISIONS					DO NOT SCALE DRAWING					921X		A

SolidWorks CAD File

