

**NOTES:**

1. MEETS IEC 60320 SPECIFICATION
2. AGENCY IDENTIFICATION & RATING:  
UL & CSA: 15A, 250V AC  
VDE: 10A, 250V AC
3. MATERIALS:  
HOUSING: BLACK POLYESTER  
PINS: TIN PLATED COPPER ALLOY
4. THIS PRODUCT IS RoHS COMPLIANT.

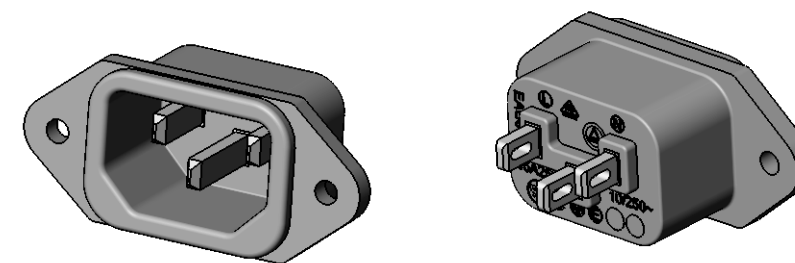

**CUSTOMER DRAWING**

|  |            |         |    |      |  |       |          |                   |        |
|--|------------|---------|----|------|--|-------|----------|-------------------|--------|
|  |            |         |    |      | THIS DRAWING DESCRIBES A DESIGN CONSIDERED PROPRIETARY IN NATURE, DEVELOPED AND MANUFACTURED BY SWITCHCRAFT INC. AND IS RELEASED ON A CONFIDENTIAL BASIS FOR IDENTIFICATION PURPOSES ONLY. |       |          |                   |        |
|  |            |         |    |      | SIZE   | WIDTH | MULT     | LBS/M             | TEMPER |
| UNLESS OTHERWISE SPECIFIED<br>1. ALL DIMENSIONS IN INCHES<br>- TWO PLACE DECIMALS ±0.02<br>- THREE PLACE DECIMALS ±0.005 |            |         |    |      | FINISH   |       | MATERIAL |                   |        |
|  |            |         |    |      | SPEC No.   |       | SPEC No. |                   |        |
| REVISIONS  |            |         |    |      | FIRST USED ON  |       | SCALE    |                   |        |
|  |            |         |    |      | DATE DRAWN   |       | BY       |                   | CHKD   |
| A  | 27299      | 5-30-14 | TO | TJK  | 11/17/11   | BL    | 11/17/11 | 11/17/11          | TJK    |
| REV  | ECO NUMBER | DATE    | BY | APVD | NAME MALE AC RECEPTACLE<br>SOLDER TERMINALS, RoHS  |       |          | PART No. EAC 301X |        |
| DO NOT SCALE DRAWING   |            |         |    |      | SHEET 1 OF 1   |       |          |                   |        |
|  |            |         |    |      | REV A  |       |          | REV A             |        |