

CUSTOMER PRINT

PART NUMBER: 13280-XXSG-3XX

- NOTES:  
 1. PARTS TO BE BULK PACKED.  
 2. ALL DIMENSIONS REFERENCE ONLY.

KIT P/N	NO. OF CONTACTS
13280-18SG-3XX	18 #20
13280-20SG-3XX	20 #20
13280-XXSG-3XX	

— GROMMET SIZE  
 — NO. OF CONTACTS

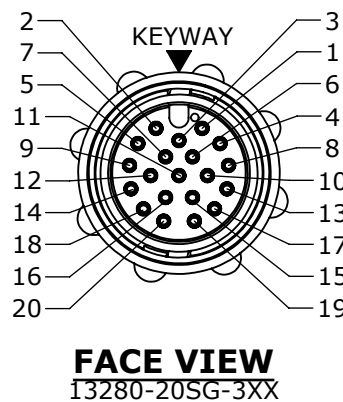
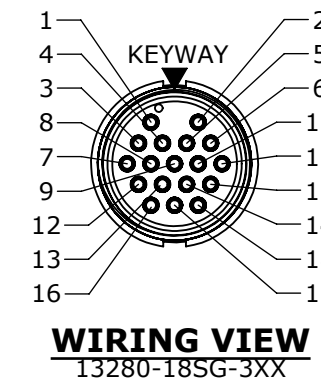
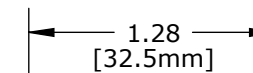
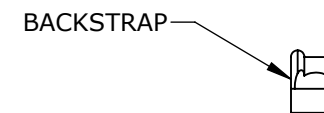
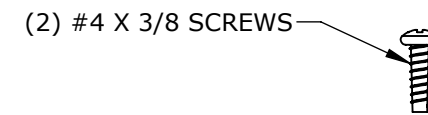
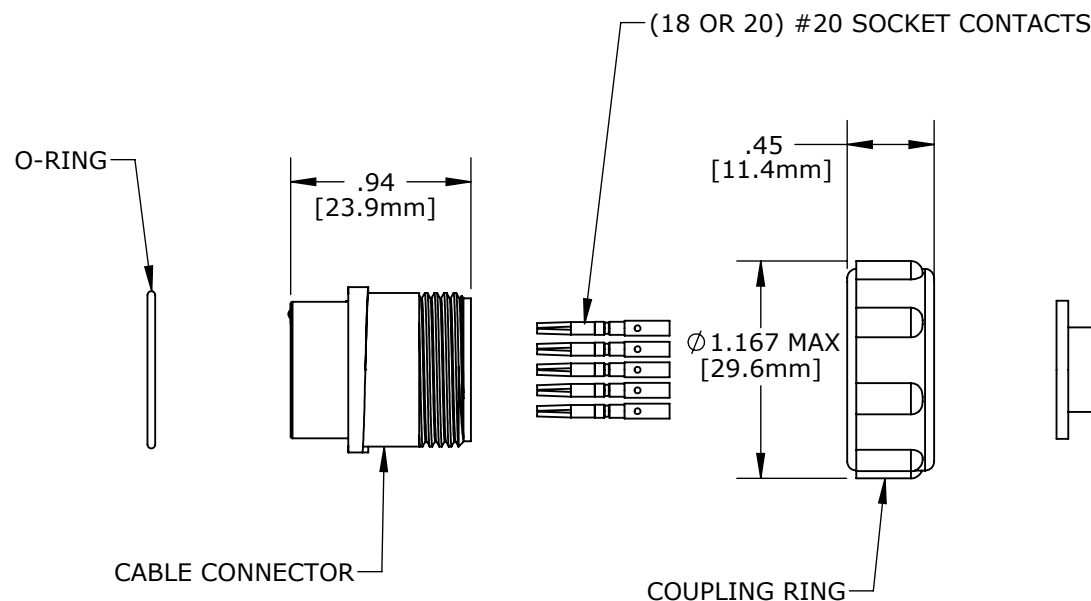
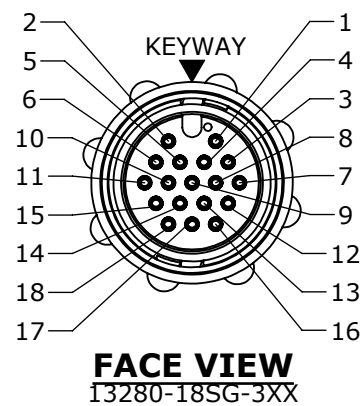

GROMMET  
 P/N: 13280-XSG-321 (.250 I.D. FOR CABLES .21-.25 [5.3-6.3mm] O.D.)  
 P/N: 13280-XSG-326 (.280 I.D. FOR CABLES .26-.30 [6.6-7.6mm] O.D.)  
 P/N: 13280-XSG-331 (.370 I.D. FOR CABLES .31-.38 [7.8-9.6mm] O.D.)

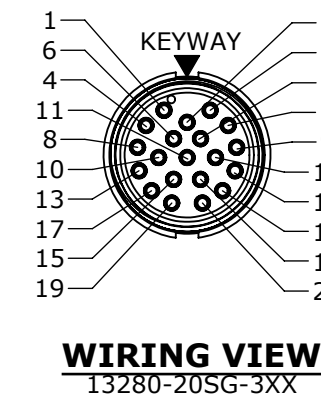

KIT P/N	CABLE O.D.
13280-XXSG-321	.21-.25 [5.3-6.3mm]
13280-XXSG-326	.26-.30 [6.6-7.6mm]
13280-XXSG-331	.31-.38 [7.8-9.6mm]

**CUSTOMER APPROVAL**

THIS DOCUMENT CONTAINS CONFIDENTIAL INFORMATION PROPRIETARY TO CONXALL CORPORATION. ANY REPRODUCTION, DISCLOSURE, OR USE OF THIS DOCUMENT / INFORMATION IS EXPRESSLY PROHIBITED UNLESS AUTHORIZED IN WRITING BY CONXALL CORPORATION.

APPROVED BY: \_\_\_\_\_  
 DATE: \_\_\_\_\_

**RoHS COMPLIANT**

DIMENSIONS IN BRACKETS [ ] ARE METRIC

REV.	INIT.	DATE	DESCRIPTION
A	BZ	01-29-10	DRAWING CREATED PER DOR 10-E149SL
<small>ALL INFORMATION ILLUSTRATED IS THE PROPERTY OF CONXALL CORPORATION. UNAUTHORIZED DUPLICATION OR DISTRIBUTION OF THIS DOCUMENT IS PROHIBITED.</small>			ORIG. DRAWN BY: BZ DATE: 01-29-10 CHECKED BY:
<small>ALL UNITS ARE IN FEET, INCHES, FRACTION OF INCHES AND DECIMALS.</small>			APPROVED BY: SCALE: NTS SIZE: B SHEET: 1 OF 1
<small>— CRITICAL CHARACTERISTIC FLAG PER SPEC. XXXX</small>			TITLE: CABLE CONNECTOR KIT (18 & 20) #20 SOCKET CONTACTS MAXI-CON-X CUSTOMER: STANDARD PRODUCT PART NUMBER: 13280-XXSG-3XX REV: A

