

NOTES:

1. MATERIALS:
HOUSING - THERMOPLASTIC, BLACK
TERMINALS - COPPER ALLOY, SILVER PLATED (B)
2. SUPPLIED ON TAPE AND REEL, SEE SHEET 2
3. THIS PRODUCT IS RoHS COMPLIANT.

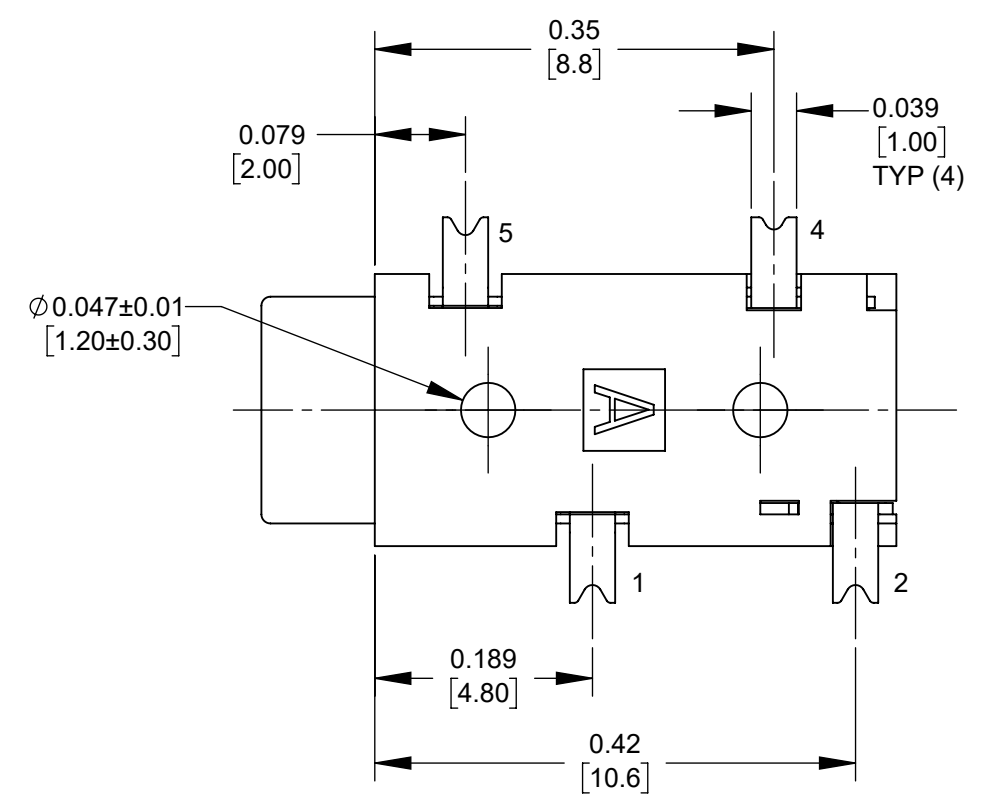

PCB LAYOUT (B)
COMPONENT SIDE
TOLERANCE: ±0.002 [±0.05]

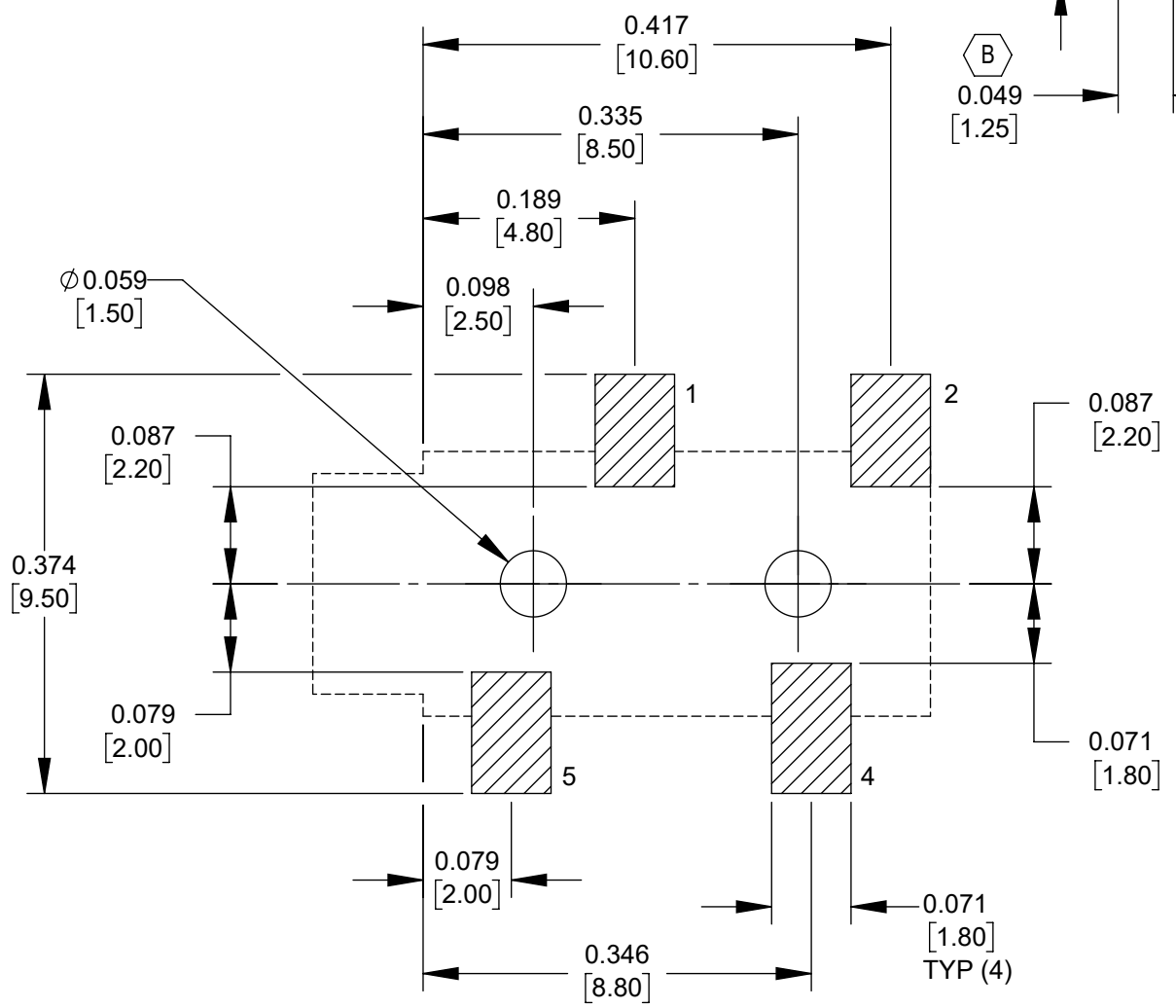
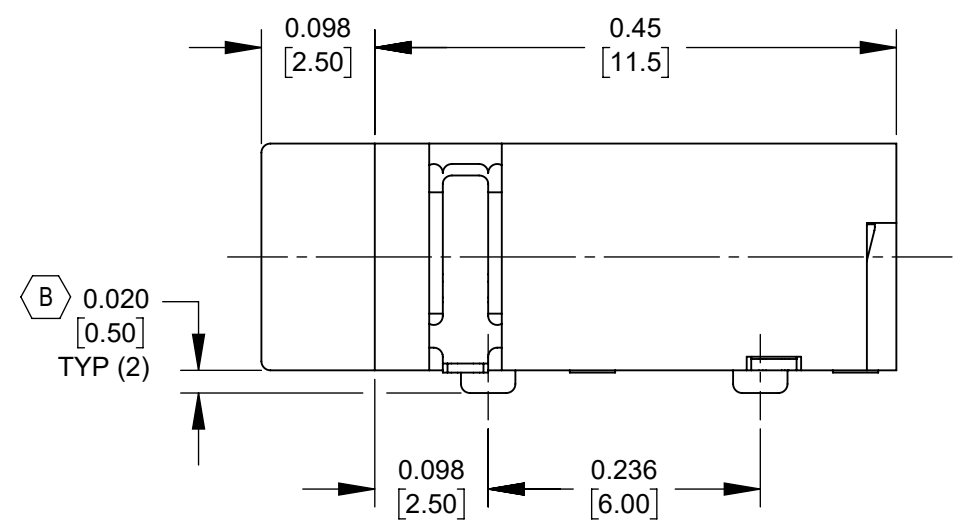
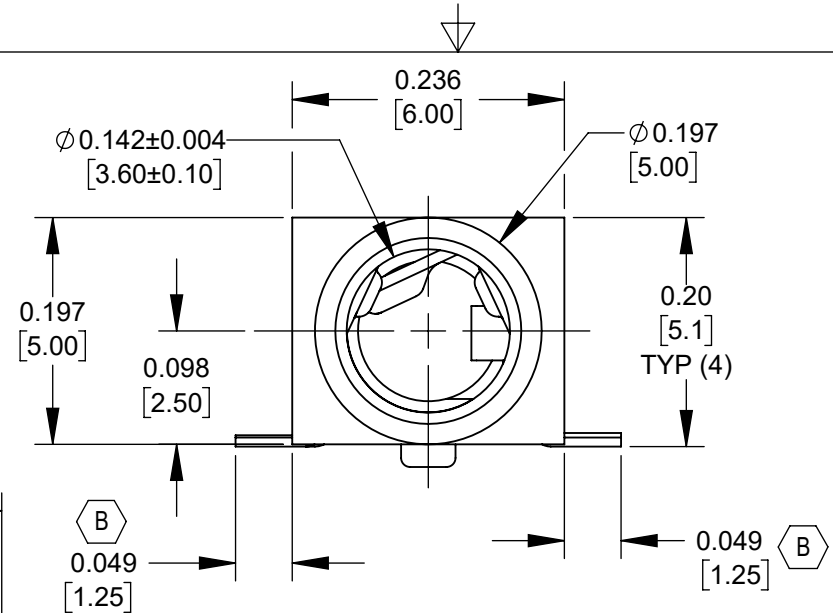
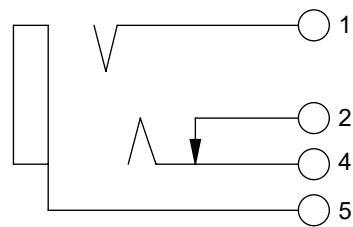

SCHMATIC

CUSTOMER DRAWING

REV	ECO NUMBER	DATE	BY	APVD
B	28596	06/07/23	PC	TJK
A	28463	01/31/22	PC	TJK

UNLESS OTHERWISE SPECIFIED
1. ALL DIMENSIONS IN INCHES [mm]
- TWO PLACE DECIMALS ±0.02 [0.5]
- THREE PLACE DECIMALS ±0.005 [0.13]

DO NOT SCALE DRAWING

THIS DRAWING DESCRIBES A DESIGN CONSIDERED PROPRIETARY IN NATURE, DEVELOPED AND MANUFACTURED BY SWITCHCRAFT INC. AND IS RELEASED ON A CONFIDENTIAL BASIS FOR IDENTIFICATION PURPOSES ONLY.									
SIZE	WIDTH	MULT	LBS/M	TEMPER					
FINISH					MATERIAL				
SPEC No.					SPEC No.				
FIRST USED ON					SCALE				
					6:1				
DATE DRAWN	BY	CHKD	APVD						
1/26/22	PC	TJK	TJK						
			1/26/22						
NAME					PART No.				
3.5 MM PHONE JACK					35RASMT3BHSNTRX				
SURFACE MOUNT, RoHS					REV				
					B				

A: CARRIER SIZE

1. DETAIL SIZE REFERENCES: EIA-481

B 2. SPECIFICATIONS: 24 MM X 12 MM

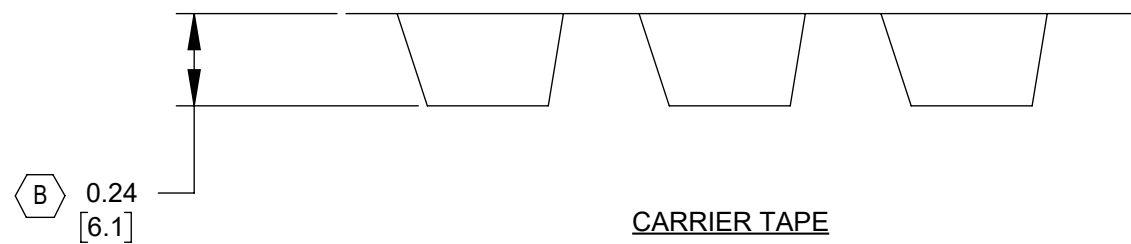
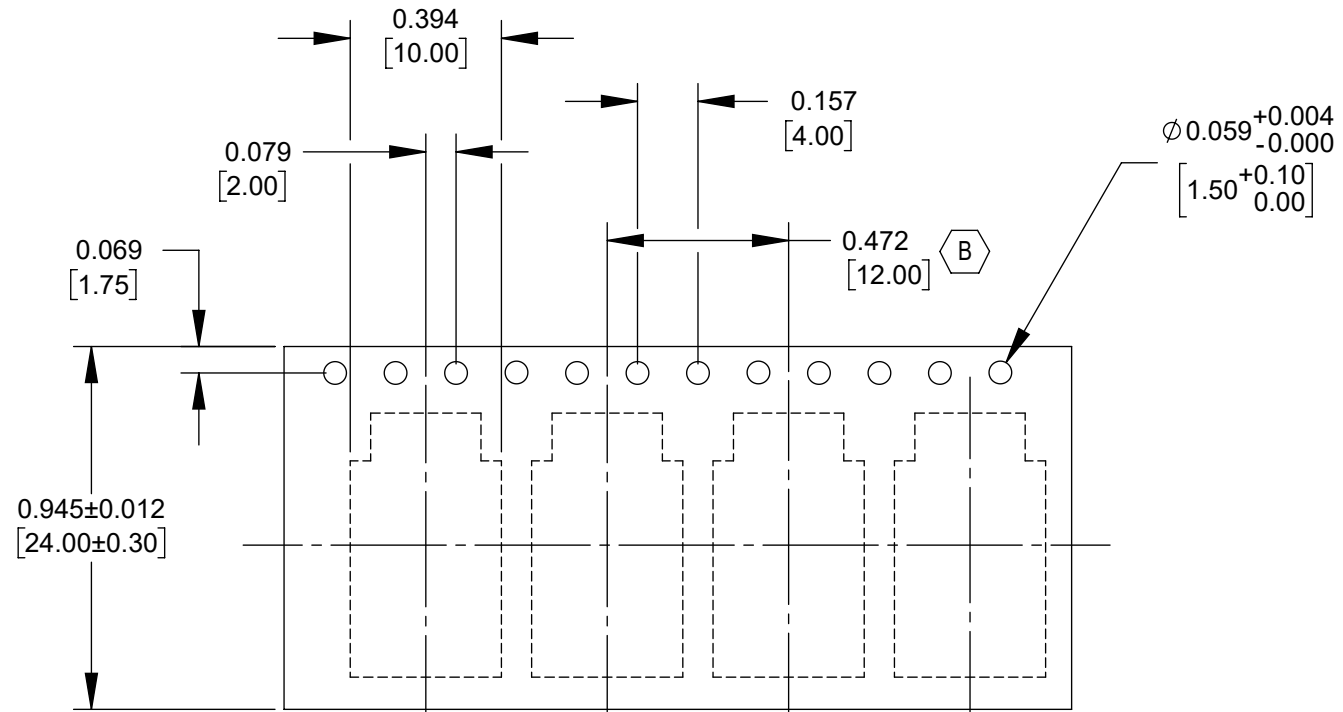

B: REEL SIZE

B 1. QUANTITY: 1000 PCS/REEL

2. MATERIAL: THERMOPLASTIC

3. 13 EMPTY AT START OF REEL AND 22 EMPTY AT END OF REEL

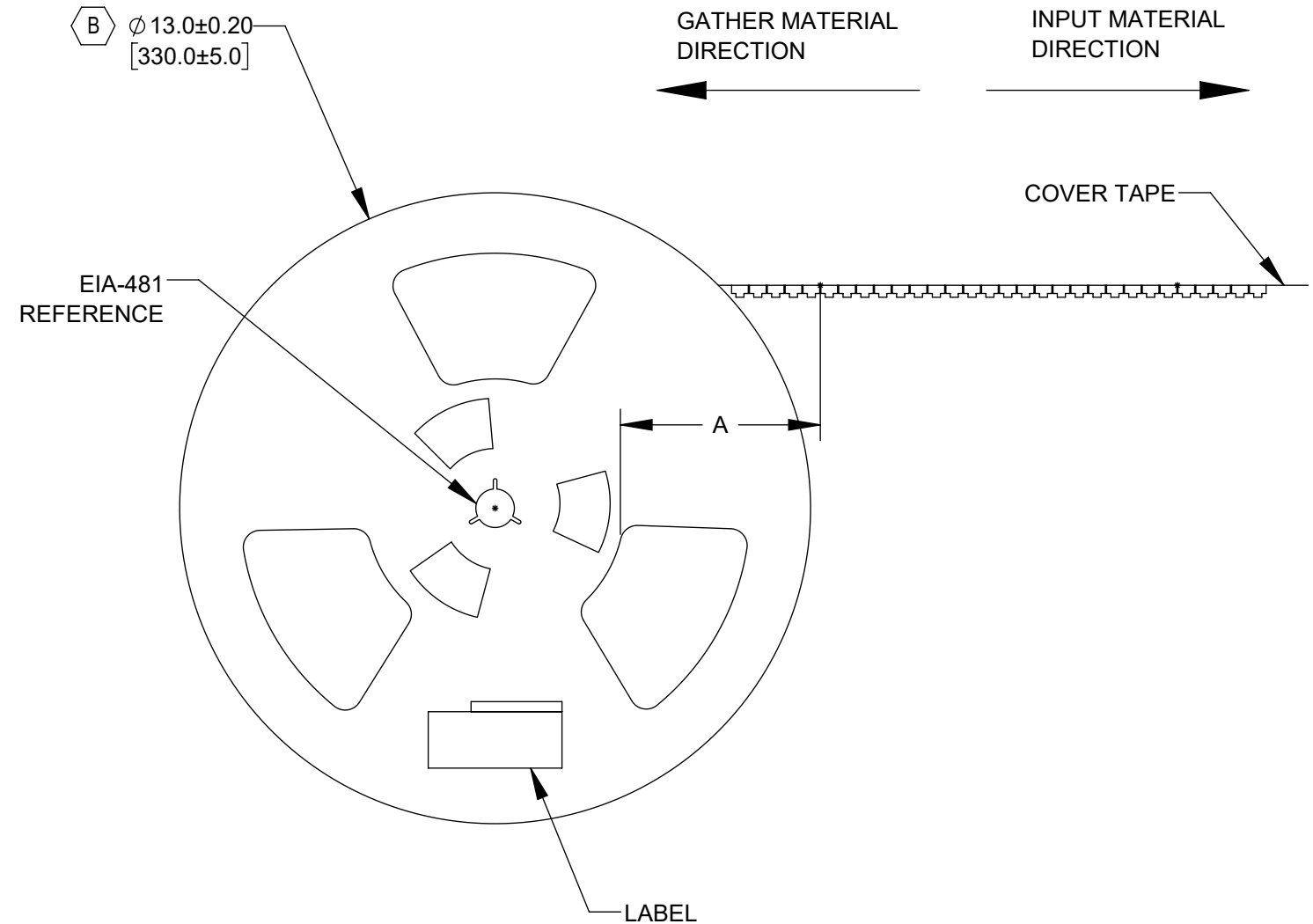

CUSTOMER DRAWING

SCALE 2:1	Switchcraft [®]	
DATE DRAWN 01/26/22		
DRAWN BY PC	PART No. 35RASMT3BHSNTRX	REV B