

Ø3.5MM MATING PLUG

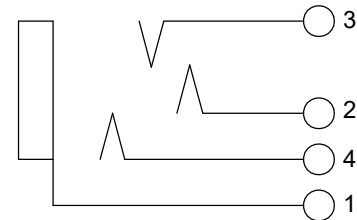

**SCHMATIC**

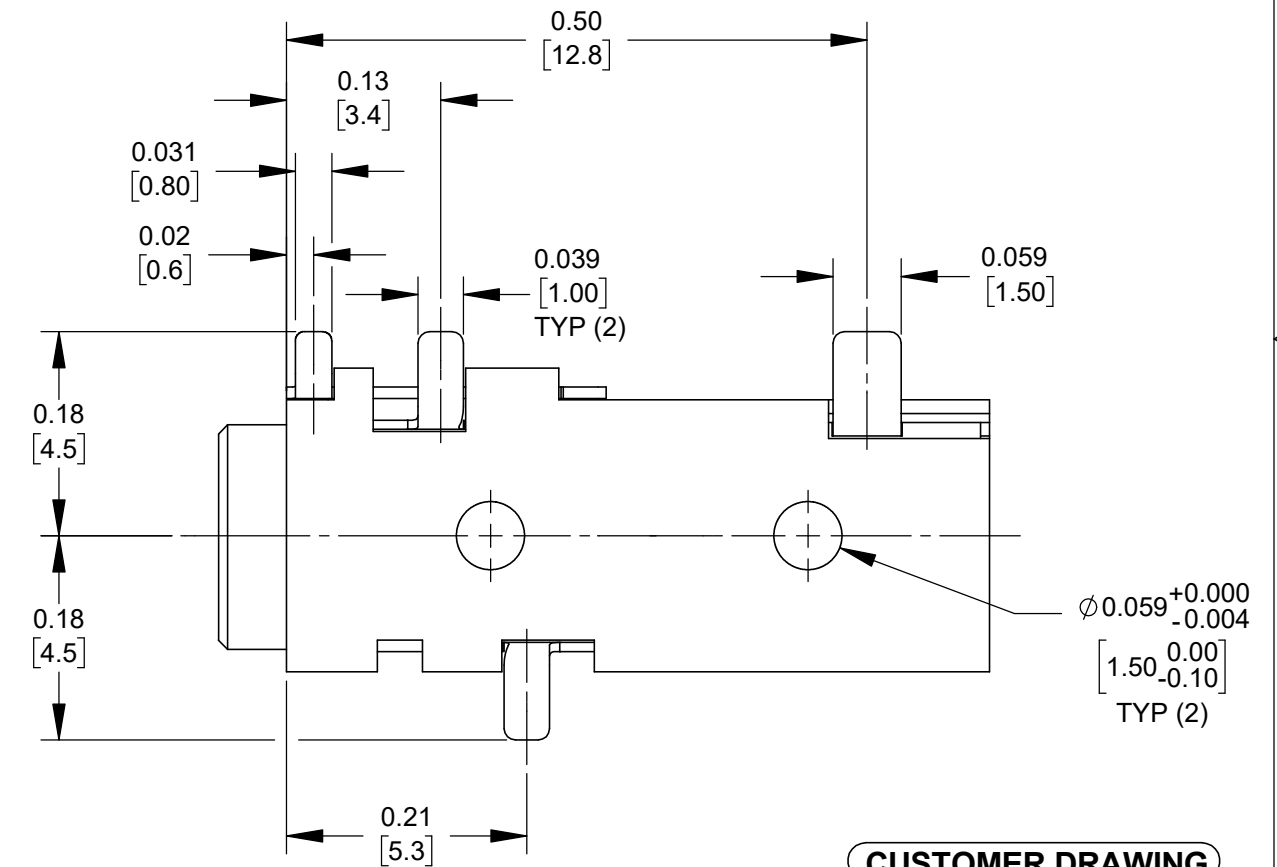

**CUSTOMER DRAWING**

**NOTES:**

- MATERIALS:  
HOUSING - THERMOPLASTIC, BLACK  
TERMINALS - COPPER ALLOY, GOLD PLATED
- SUPPLIED ON TAPE AND REEL, SEE SHEET 2.
- THIS PRODUCT IS RoHS COMPLIANT.

**PCB LAYOUT  
COMPONENT SIDE**

REV	ECO NUMBER	DATE	BY	APVD
A	28481	03/03/22	PC	TJK

REVISIONS

UNLESS OTHERWISE SPECIFIED  
1. ALL DIMENSIONS IN INCHES [mm]  
- TWO PLACE DECIMALS ±0.02 [0.5]  
- THREE PLACE DECIMALS ±0.005 [0.13]

DO NOT SCALE DRAWING

THIS DRAWING DESCRIBES A DESIGN CONSIDERED PROPRIETARY IN NATURE, DEVELOPED AND MANUFACTURED BY SWITCHCRAFT INC. AND IS RELEASED ON A CONFIDENTIAL BASIS FOR IDENTIFICATION PURPOSES ONLY.				
SIZE	WIDTH	MULT	LBS/M	TEMPER
FINISH		MATERIAL		
SPEC No.		SPEC No.		
FIRST USED ON		SCALE		
		6:1		
DATE DRAWN	BY	CHKD	APVD	<b>Switchcraft</b> <sup>®</sup>
10/27/21	TS	TS	TJK	
NAME				SHEET 1 OF 2
3.5MM JACK, 4 CONDUCTOR, SURFACE MOUNT, RoHS				PART No.
				35RASMT5CHNTRX
				REV
				A

**A: CARRIER SIZE**

1. DETAIL SIZE REFERENCES: EIA-481
2. SPECIFICATIONS: 32 MM X 12 MM
3. COVER TAPE: SPECIFICATION ATTACHED (CONDUCTIVE)

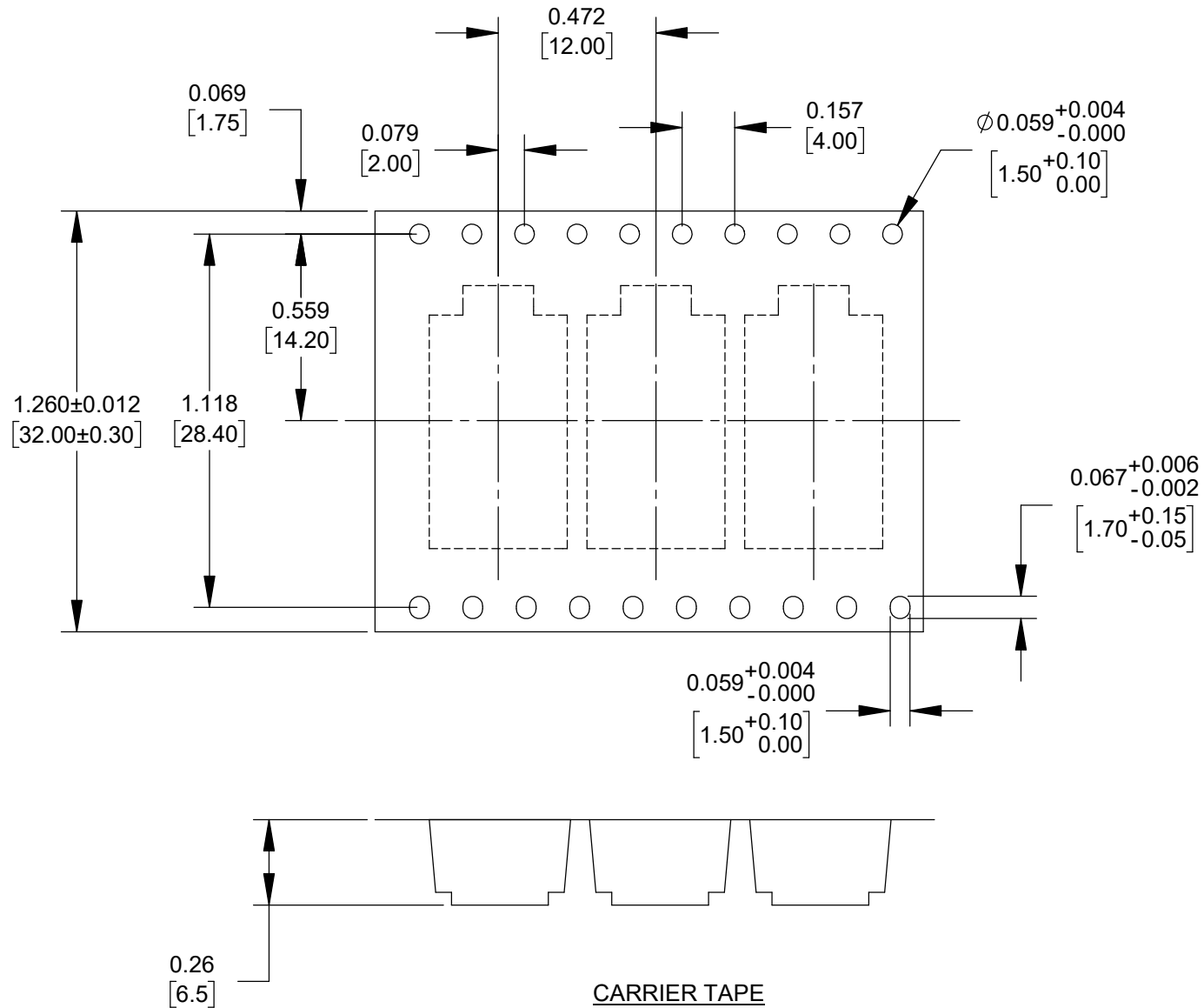

**B: REEL SIZE**

1. QUANTITY: 1000 PCS/REEL
2. MATERIAL: THERMOPLASTIC

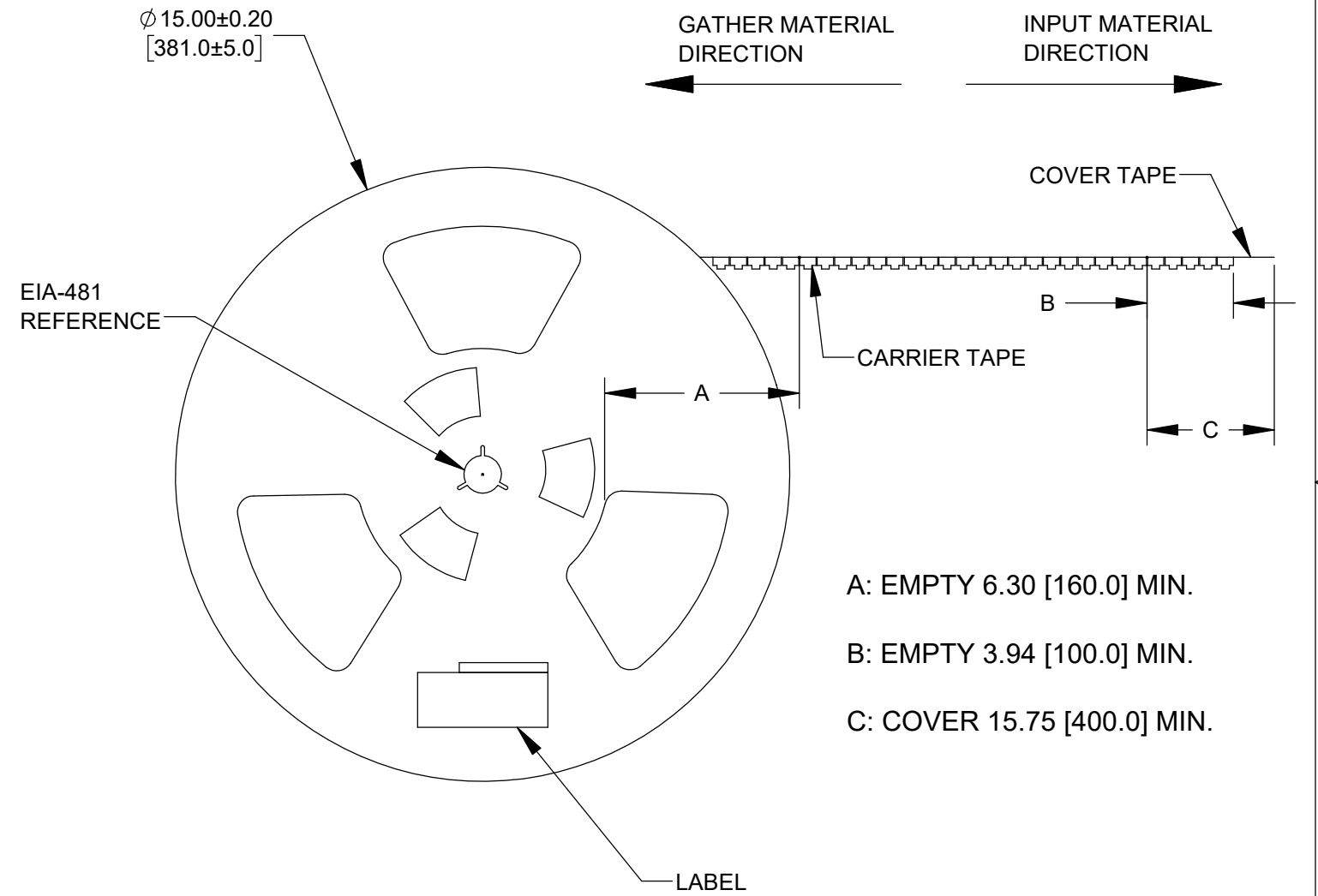

- A: EMPTY 6.30 [160.0] MIN.
- B: EMPTY 3.94 [100.0] MIN.
- C: COVER 15.75 [400.0] MIN.

**CUSTOMER DRAWING**

SCALE 2:1	<b>Switchcraft</b> <sup>®</sup>	
DATE DRAWN 3/1/22		
DRAWN BY TJK	PART No. 35RASMT5CHNTRX	REV A