

- NOTES:
1. ALL PARTS TO BE BULK PACKED.
 2. SEE DRAWING HPMUSTD FOR HOLE PATTERN.

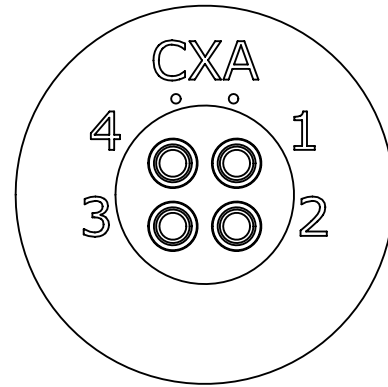

WIRING VIEW
ASSY: 4380-4PG-300

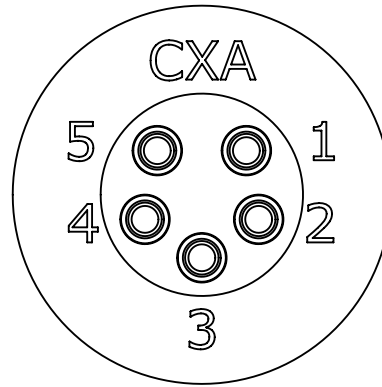

WIRING VIEW
ASSY: 4380-5PG-300

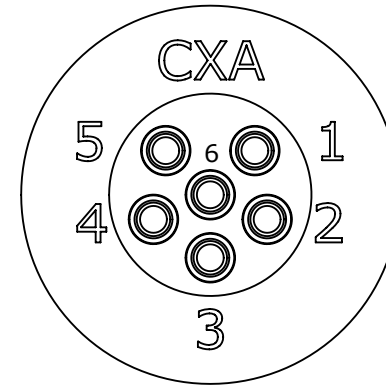

WIRING VIEW
ASSY: 4380-6PG-300

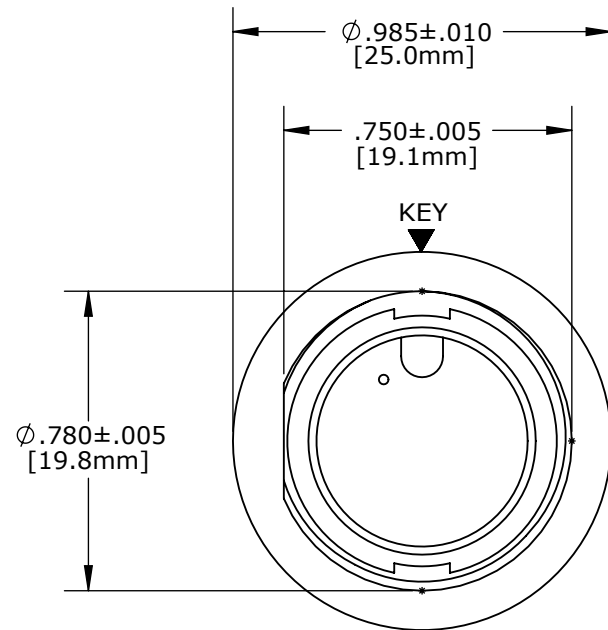

FACE VIEW

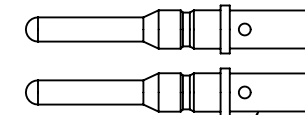
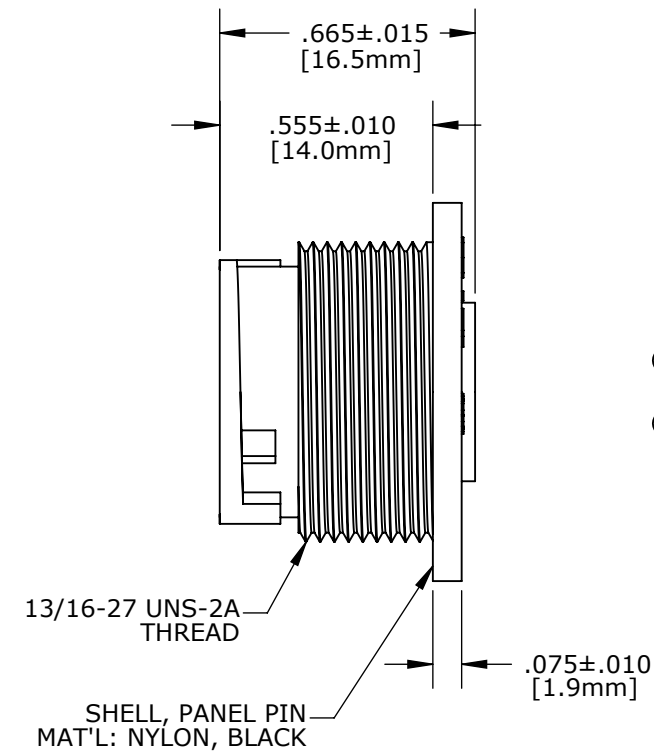
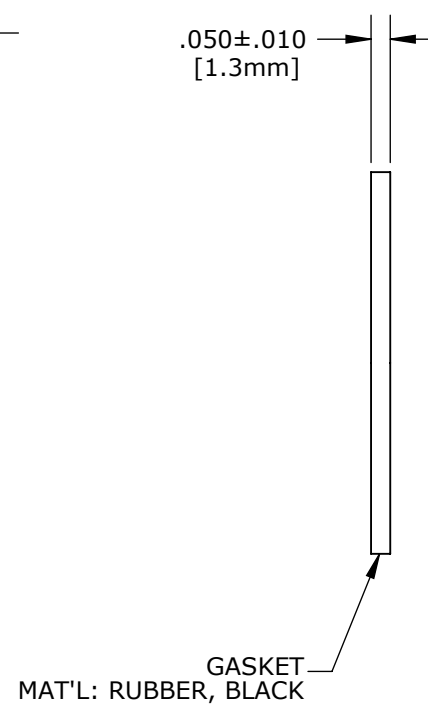
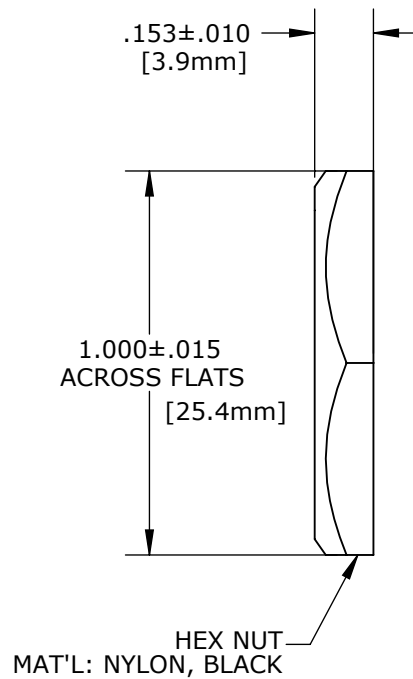

(4-6) #16 PIN CONTACTS
CRIMP TAIL
MAT'L: GOLD PLATED COPPER ALLOY

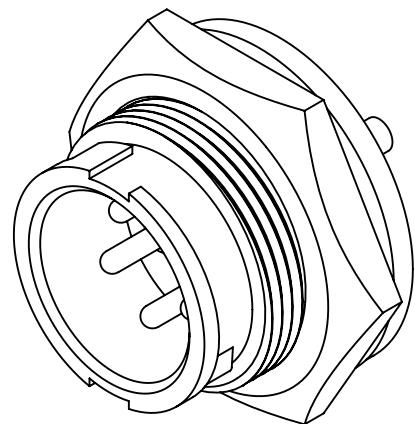

SHOWN ASSEMBLED KIT
FOR CUSTOMER REFERENCE ONLY

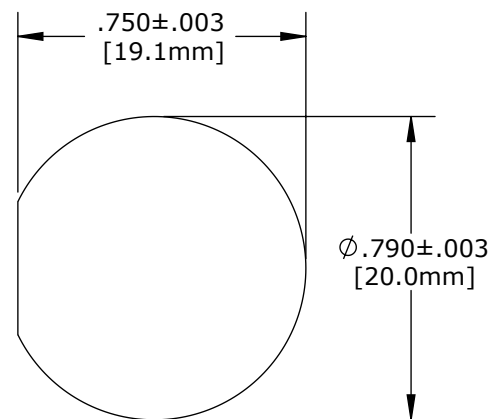

**RECOMMENDED
PANEL CUT OUT**

CUSTOMER APPROVAL

THIS DOCUMENT CONTAINS CONFIDENTIAL INFORMATION PROPRIETARY TO CONXALL CORPORATION. ANY REPRODUCTION, DISCLOSURE, OR USE OF THIS DOCUMENT / INFORMATION IS EXPRESSLY PROHIBITED UNLESS AUTHORIZED IN WRITING BY CONXALL CORPORATION.

APPROVED BY: _____

DATE: _____

RoHS COMPLIANT

ASS'Y P/N	CONTACT QTY.
4380-4PG-300	4 #16
4380-5PG-300	5 #16
4380-6PG-300	6 #16

A		AN		03-04-11		DRAWING CREATED PER DOR 11-E149SL SUPERSEDED 4380-4PG-300					
REV.		INIT.		DATE		DESCRIPTION					
ALL INFORMATION ILLUSTRATED IS THE PROPERTY OF CONXALL CORPORATION. UNAUTHORIZED DUPLICATION OR DISTRIBUTION OF THIS DOCUMENT IS PROHIBITED.						ORIG. DRAWN BY: DATE:			 601 E. WILDWOOD VILLA PARK, IL 60181		
						AN 03-04-11					
ALL UNITS ARE IN FEET, INCHES, FRACTION OF INCHES AND DECIMALS.						CHECKED BY:			TITLE: PANEL MOUNT ASSEMBLY (4-6) #16 PIN CONTACTS MULTI-CON-X CUSTOMER: STANDARD PRODUCT		
▷ = CRITICAL CHARACTERISTIC FLAG PER SPEC. XXXX						APPROVED BY:			PART NUMBER: 4380-XPG-300		
						SCALE	SIZE	SHEET			
						NTS	B	1 OF 1			
FILE: 4380-XPG-300						DIRECTORY: SLW			REV A		

DIMENSIONS IN BRACKETS [] ARE METRIC