

#### NOTES:

##### 1. MATERIALS:

CORDETTE SWITCH:  
HOUSING - THERMOPLASTIC, WHITE  
BUTTON - THERMOPLASTIC, BLACK  
CONTACTS - COPPER ALLOY, GOLD PLATED  
OVERMOLD - THERMOPLASTIC, GRAY

##### RCA JACK:

HOUSING - COPPER ALLOY, BRIGHT NICKEL  
RECEPTACLE - COPPER ALLOY, MATTE TIN  
INSULATORS - PHENOLIC & THERMOPLASTIC

##### 2. THIS PRODUCT IS RoHS COMPLIANT.

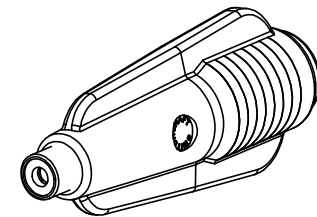
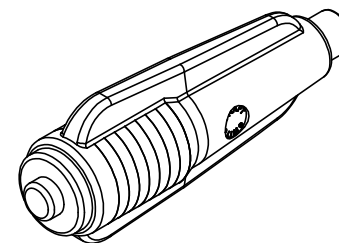

**CUSTOMER DRAWING**

					<div>UNLESS OTHERWISE SPECIFIED</div> <div>1. ALL DIMENSIONS IN INCHES</div> <div>- TWO PLACE DECIMALS     ±0.02</div> <div>- THREE PLACE DECIMALS    ±0.005</div>	THIS DRAWING DESCRIBES A DESIGN CONSIDERED PROPRIETARY IN NATURE, DEVELOPED AND MANUFACTURED BY SWITCHCRAFT INC. AND IS RELEASED ON A CONFIDENTIAL BASIS FOR IDENTIFICATION PURPOSES ONLY.								
						SIZE	WIDTH		MULT	LBS/M	TEMPER			
						FINISH				MATERIAL				
						SPEC No.				SPEC No.				
						FIRST USED ON			SCALE		<div>Switchcraft®</div> <div>SHEET    1                      OF            1</div>			
B	28687	07-02-24	TO	TJK		DATE DRAWN	BY	CHKD	APVD					
A	26210	1-17-07	TO	TJK		08-29-11	JEB	JEB	TJK					
							08-29-11	11-10-15						
REV	ECO NUMBER	DATE	BY	APVD	NAME					PART No.		REV		
REVISIONS					DO NOT SCALE DRAWING		ST-900 CORDETTE SWITCH TO ST-60 RCA JACK, RoHS					921X		B

SolidWorks CAD File

