

NOTES:

1. PANEL CONNECTORS TO BE PACKED IN PARTITION BOX, 100 PC PER BOX
HEX NUT AND GASKET TO BE BULK PACKED IN A SEPARATE BAG FROM PANEL
ASSEMBLY PACKAGE.
a) BOX LABELED WITH CXA PART NUMBER, QUANTITY, LOT # AND DATE
CODE AS SHOWN.
2. CONTACTS ARE ASSEMBLED INTO PANEL CONNECTOR.
3. BACK END OF CONNECTOR FILLED WITH EPOXY
4. SEE DRAWING HPMCSTD FOR HOLE PATTERN.
5. ALL DIMENSIONS ARE REFERENCE EXCEPT THOSE WITH A TOLERANCE

B

P/N: W17984-XPG-P-3ES
CONXALL
QTY:
Lot:
Date Code:

ASS'Y P/N	NO. OF CONTACTS	KEY STYLE
W17984-5PG-P-3ES	5 #26	A-KEY
W17984-6PG-P-3ES	6 #26	B-KEY
W17984-7PG-P-3ES	7 #26	A-KEY

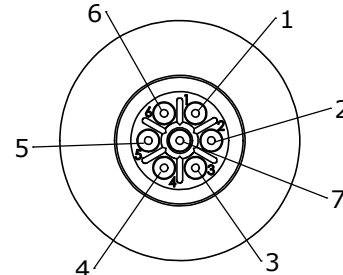
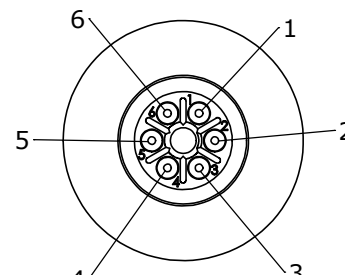
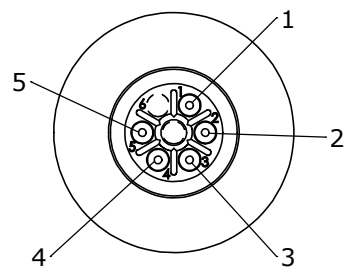
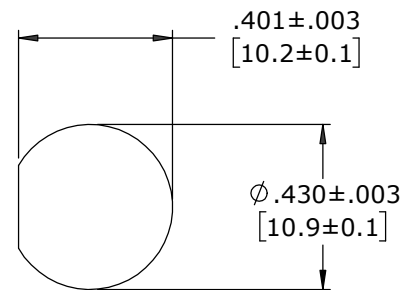
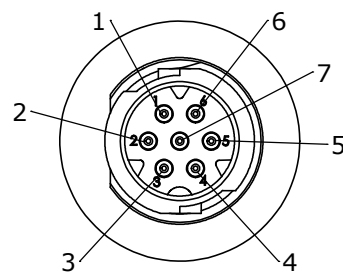
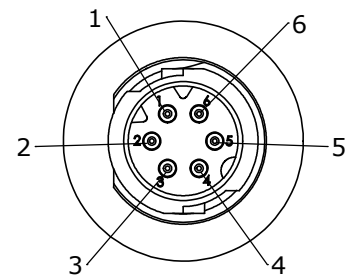
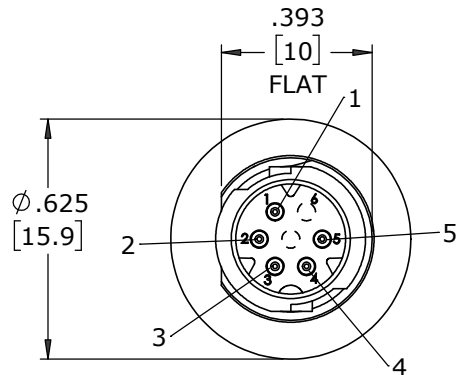
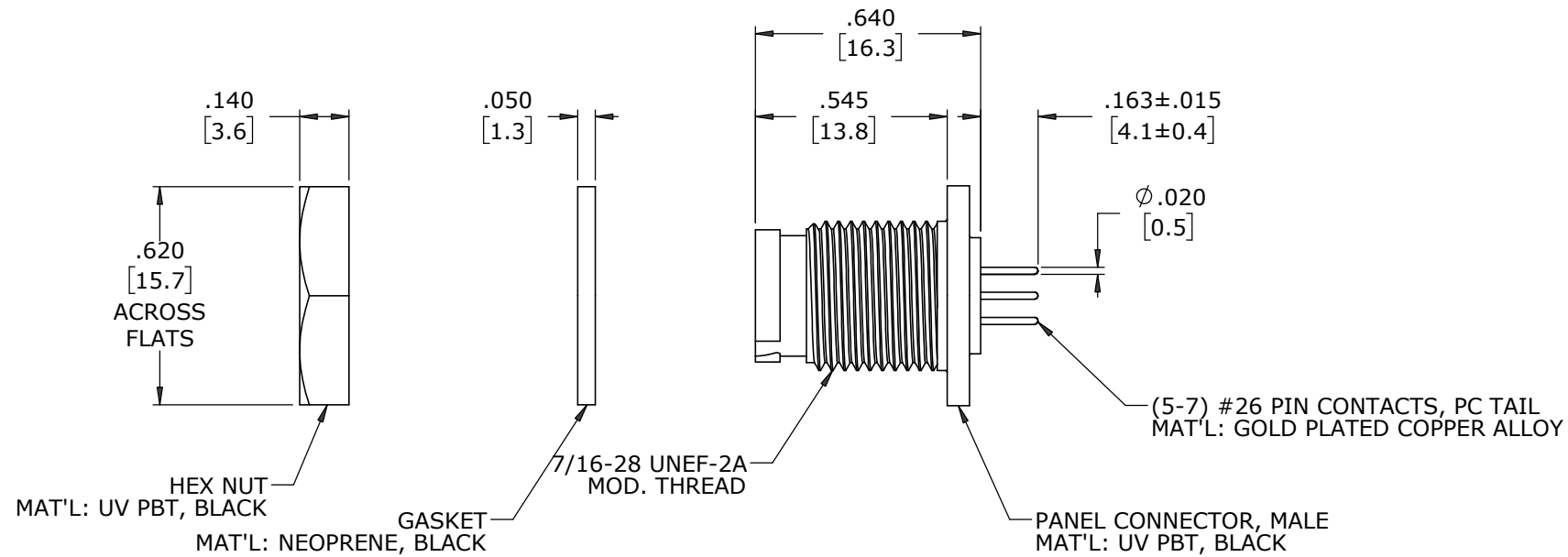

CUSTOMER APPROVAL

THIS DOCUMENT CONTAINS CONFIDENTIAL INFORMATION PROPRIETARY TO CONXALL CORPORATION. ANY REPRODUCTION, DISCLOSURE, OR USE OF THIS DOCUMENT /INFORMATION IS EXPRESSLY PROHIBITED UNLESS AUTHORIZED IN WRITING BY CONXALL CORPORATION.

APPROVED BY: _____
DATE: _____

B	MA	11-09-20	NUMBER OF CONNECTORS PER BOX WAS 200 PER ECR 9548
A	MA	08-11-20	DRAWING CREATED PER PDR 18004-2
REV.	INIT.	DATE	DESCRIPTION
MA		0-11-20	ORIG. DRAWN BY: DATE: MA 0-11-20
			CHECKED BY:
			APPROVED BY:
			SCALE SIZE SHEET NTS B 1 OF 1
			FILE: W17984-XPG-P-3ES DIRECTORY: SLW
			PART NUMBER: W17984-XPG-P-3ES
			REV B

conxall
601 E. WILDWOOD VILLA PARK, IL 60181

TITLE: PANEL MOUNT ASSEMBLY
(5-7) #26 PIN CONTACTS, PC TAIL
INSTA-CLICK™ MICRO-CON-X
STANDARD PRODUCT

DIMENSIONS IN BRACKETS [] ARE IN MILLIMETERS UNLESS INDICATED

RoHS COMPLIANT

▷ = CRITICAL CHARACTERISTIC
FLAG PER SPEC. XXXX