

CUSTOMER PRINT

PART NUMBER: W18880-4SG-P-5XX

- NOTES:
- 1. ALL PARTS ARE BULK PACKED
 - 2. CONTACTS SHIPPED UNASSEMBLED
 - 3. ALL DIMENSIONS ARE REFERENCE EXCEPT THOSE WITH A TOLERANCE

| ASS'Y P/N | FOR CABLE O.D. |
|------------------|---------------------|
| W18880-4SG-P-518 | .175-.185 [4.4-4.7] |
| W18880-4SG-P-521 | .205-.215 [5.2-5.5] |
| W18880-4SG-P-522 | .215-.225 [5.5-5.7] |

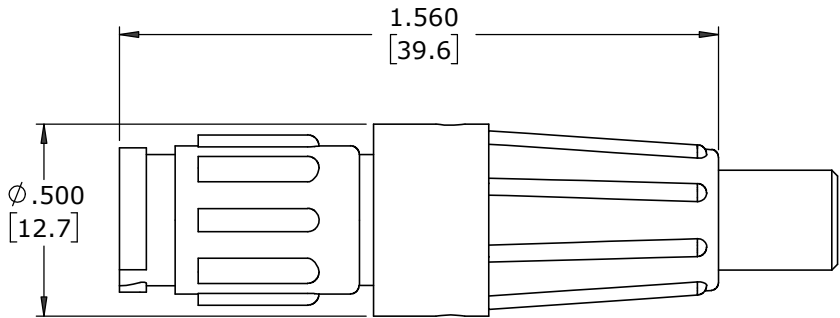
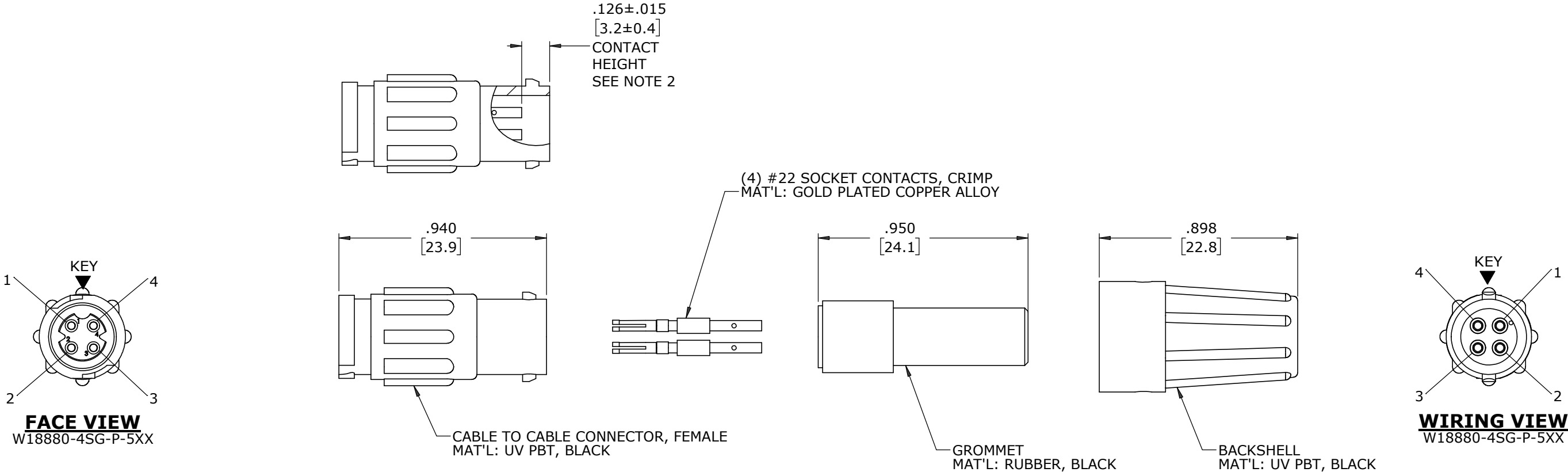

SHOWN ASSEMBLED
FOR CUSTOMER REFERENCE ONLY

DIMENSIONS IN BRACKETS [] ARE IN MILLIMETERS

| | | | | | | | | | | | | | |
|---|--|--|--|---|--|---|----------|---------------------------------|--|--|--|-------|--------------|
| CUSTOMER APPROVAL | | | | | | | | | | | | | |
| THIS DOCUMENT CONTAINS CONFIDENTIAL INFORMATION PROPRIETARY TO CONXALL CORPORATION. ANY REPRODUCTION, DISCLOSURE, OR USE OF THIS DOCUMENT /INFORMATION IS EXPRESSLY PROHIBITED UNLESS AUTHORIZED IN WRITING BY CONXALL CORPORATION. | | | | A | | MA | 08-20-20 | RELEASED PER PDR 18004 | | | | | |
| | | | | | | JGK | 8/27/19 | DRAWING CREATED FOR PDR #18004. | | | | | |
| | | | | REV. | | INIT. | DATE | DESCRIPTION | | | | | |
| | | | | | | | | | | | | | |
| APPROVED BY: _____ DATE: _____ | | | | <div>ALL INFORMATION ILLUSTRATED IS THE PROPERTY OF "CONXALL CORPORATION". UNAUTHORIZED DUPLICATION OR DISTRIBUTION OF THIS DOCUMENT IS PROHIBITED.</div> | | ALL UNITS ARE IN FEET, INCHES, FRACTION OF INCHES AND DECIMALS. UNLESS OTHERWISE SPECIFIED TOLERANCES: 3 PLACE DECIMALS ±.005 ANGLES ±1° FRACTIONS ±1/16 = CRITICAL CHARACTERISTIC FLAG PER SPEC. XXXX | | ORIG. DRAWN BY: JGK | | DATE: 8/27/19 | <div>conxall</div> <div>601 E. WILDWOOD VILLA PARK, IL 60181</div> | | |
| | | | | | | | | CHECKED BY: | | | | | |
| | | | | | | | | APPROVED BY: | | TITLE: CABLE TO CABLE CONN. ASS'Y (4) #22 SOCKET CONTACTS, CRIMP INSTA-CLICK™ MICRO-CON-X STANDARD PRODUCT | | | |
| | | | | | | | | SCALE NTS | | SIZE B | | | SHEET 1 OF 1 |
| RoHS COMPLIANT | | | | ➤ | | | | FILE: W18880-4SG-P-5XX | | DIRECTORY: SLW | PART NUMBER: W18880-4SG-P-5XX | REV A | |

RoHS COMPLIANT