

NOTES:

1. PARTS TO BE BULK PACKED.
2. SOLDER CONTACTS ARE PRESSED INTO CONNECTOR WITH ALL CONTACTS FACING AWAY FROM KEY (DOWN).
3. ALL DIMENSIONS ARE FOR REFERENCE ONLY EXCEPT WHERE NOTED WITH TOLERANCE.

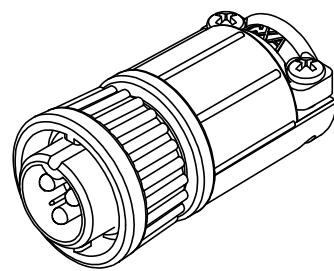

STD COUPLING RING
P/N: W3B82-7PG-5XX

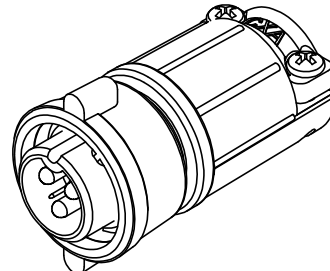

WINGED COUPLING RING
P/N: W3B82-7PG-5XXW

ASSY P/N	GROMMET SIZE
W3B82-7PG-535	GROMMET ID .375 [9.5] FOR CABLE OD .350-.400 [8.9-10.2]
W3B82-7PG-535W	

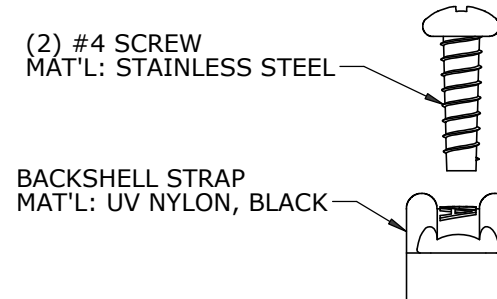

(2) #4 SCREW
MAT'L: STAINLESS STEEL

BACKSHELL STRAP
MAT'L: UV NYLON, BLACK

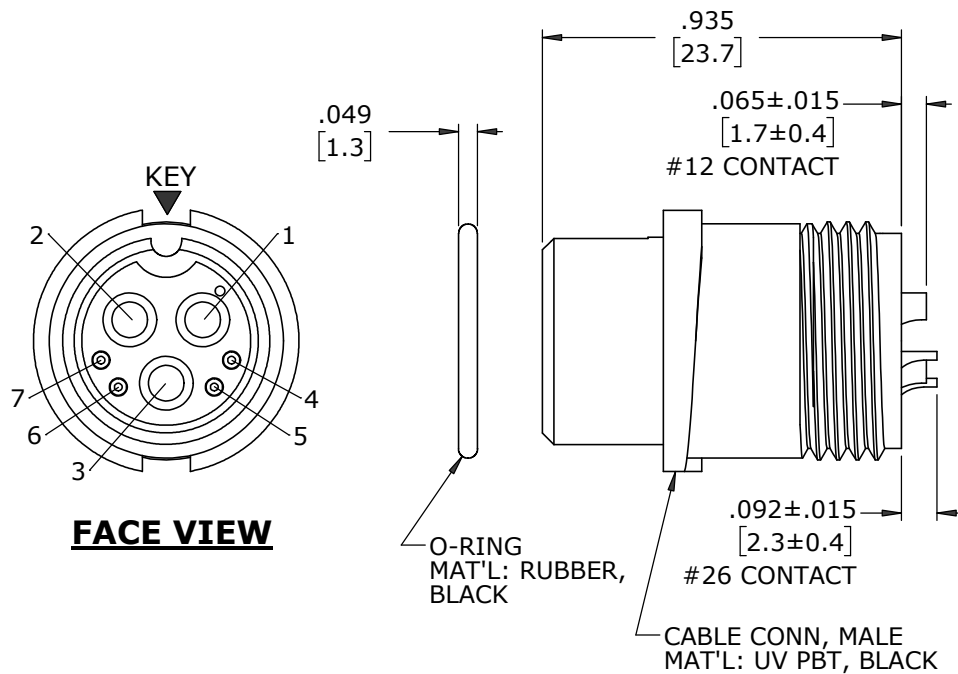

FACE VIEW

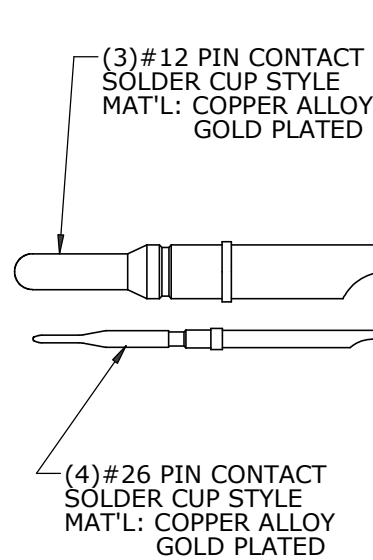

(3) #12 PIN CONTACT
SOLDER CUP STYLE
MAT'L: COPPER ALLOY
GOLD PLATED

(4) #26 PIN CONTACT
SOLDER CUP STYLE
MAT'L: COPPER ALLOY
GOLD PLATED

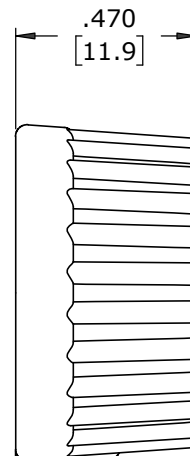

COUPLING RING, STD
MAT'L: UV PBT, BLACK

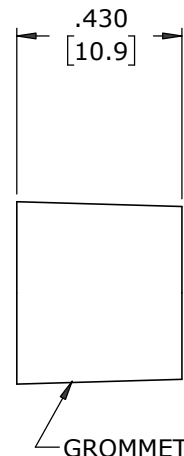

GROMMET
MAT'L: RUBBER,
BLACK



SLEEVE
MAT'L: PBT, BLACK

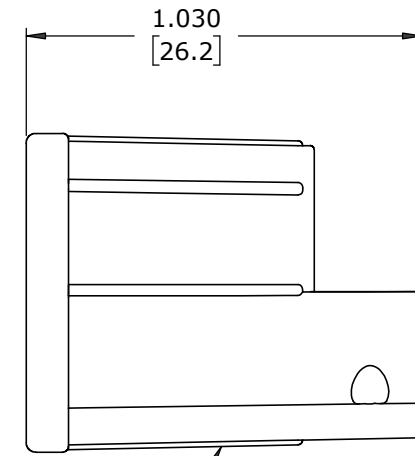

BACKSHELL
MAT'L: UV PBT, BLACK

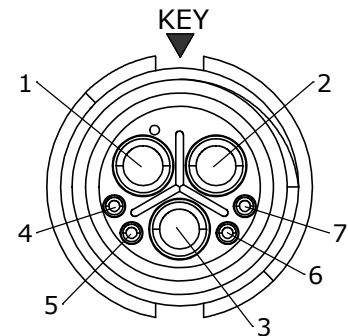

WIRE VIEW

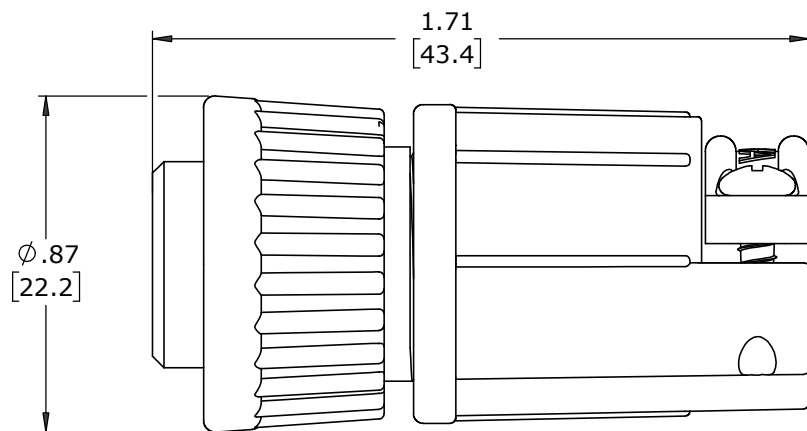

ASSEMBLED VIEW
FOR CUSTOMER REF ONLY

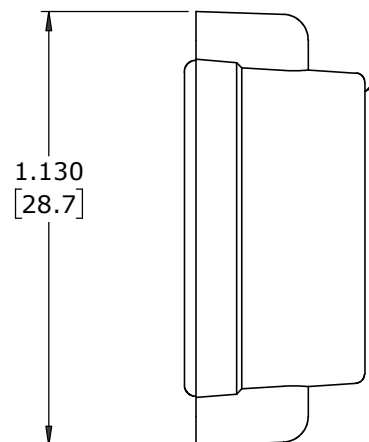

COUPLING RING, WINGED
MAT'L: UV PBT, BLACK

DIMENSIONS IN BRACKETS [] ARE METRIC.

CUSTOMER APPROVAL

THIS DOCUMENT CONTAINS CONFIDENTIAL INFORMATION PROPRIETARY TO CONXALL CORPORATION. ANY REPRODUCTION, DISCLOSURE, OR USE OF THIS DOCUMENT /INFORMATION IS EXPRESSLY PROHIBITED UNLESS AUTHORIZED IN WRITING BY CONXALL CORPORATION.

APPROVED BY: _____
DATE: _____

RoHS COMPLIANT

A	MA	09-10-24	RELEASED PER PDR 20013-3	
	AB	06-04-21	CHANGED TO ALL SOLDER CUPS FACING DOWN; P-20013-3	
		03-24-21	DRAWING CREATED PER PDR 20013	
REV.	INIT.	DATE	DESCRIPTION	
ALL INFORMATION ILLUSTRATED IS THE PROPERTY OF "CONXALL CORPORATION". UNAUTHORIZED DUPLICATION OR DISTRIBUTION OF THIS DOCUMENT IS PROHIBITED.			ORIG. DRAWN BY: AB	DATE: 03-24-21
ALL UNITS ARE IN FEET, INCHES, FRACTION OF INCHES AND DECIMALS.			CHECKED BY:	
			APPROVED BY:	
			SCALE: NTS	SIZE: B
			SHEET: 1 OF 1	
			FILE: W3B82-7PG-5XX(W)	DIRECTORY: SLW
			PART NUMBER: W3B82-7PG-5XX(W)	REV A

conxall
601 E. WILDWOOD VILLA PARK, IL 60181

TITLE: CABLE END CONNECTOR KIT
(3)#12 + (4)#26 PIN CONTACTS, SOLDER CUP
MULTI-CON-X, WEATHER RESISTANT
CUSTOMER: STANDARD PRODUCT