

NOTES:

- 1. PARTS TO BE BULK PACKED.
- 2. SOLDER CONTACTS ARE PRESSED INTO CONNECTOR, WITH ALL CONTACTS FACING AWAY FROM KEY (DOWN).
- 3. ALL DIMENSIONS ARE FOR REFERENCE ONLY EXCEPT WHERE NOTED WITH TOLERANCE.

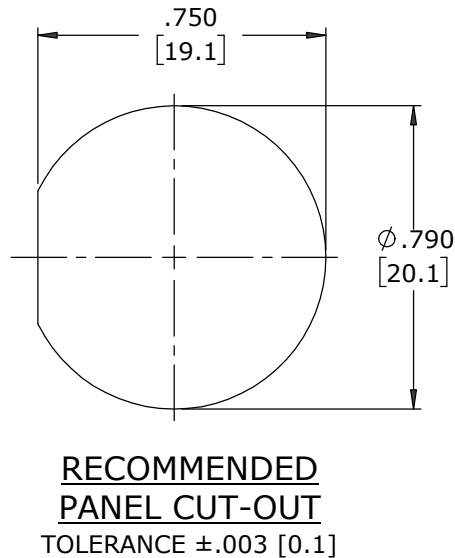
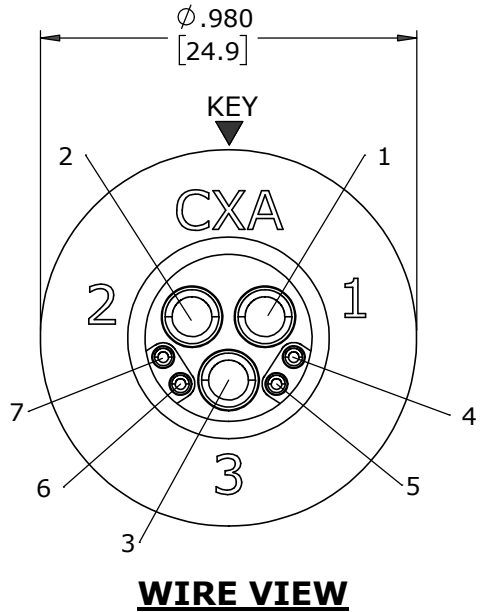
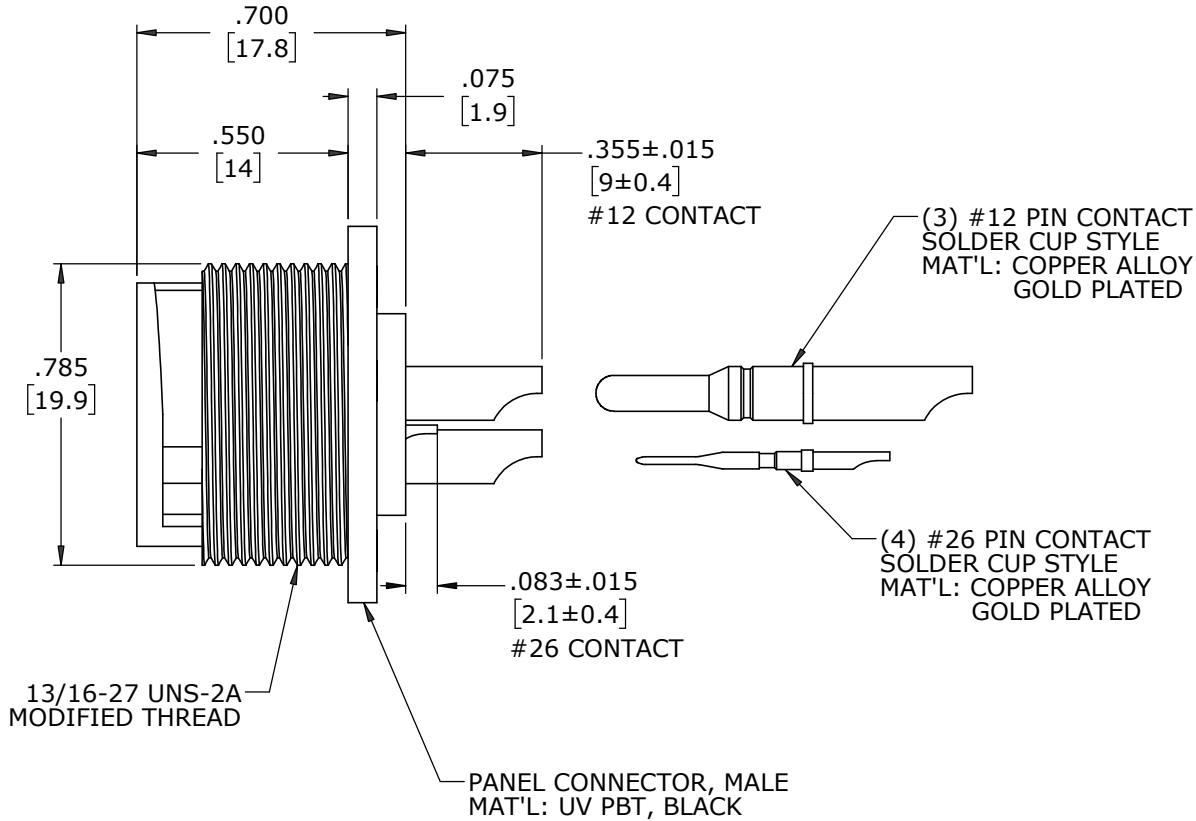
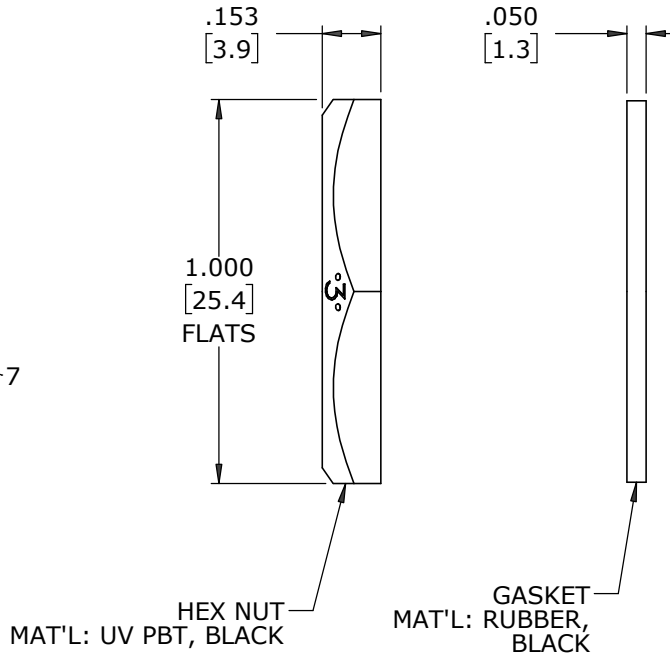
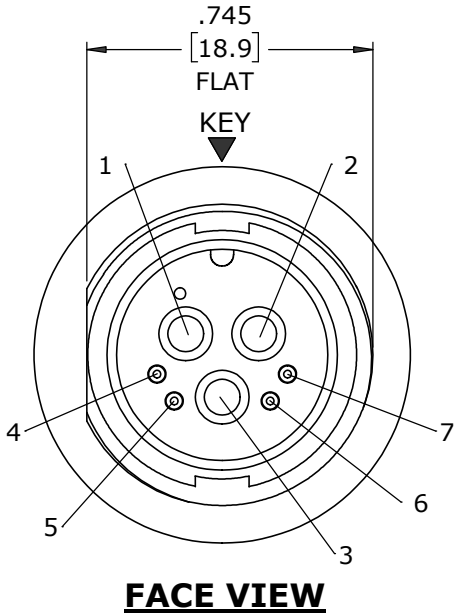
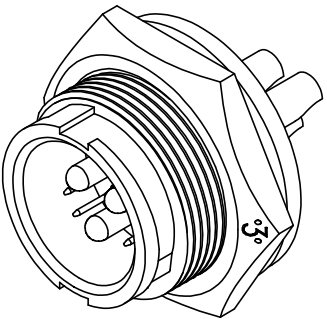

CUSTOMER APPROVAL	
THIS DOCUMENT CONTAINS CONFIDENTIAL INFORMATION PROPRIETARY TO CONXALL CORPORATION. ANY REPRODUCTION, DISCLOSURE, OR USE OF THIS DOCUMENT /INFORMATION IS EXPRESSLY PROHIBITED UNLESS AUTHORIZED IN WRITING BY CONXALL CORPORATION.	
APPROVED BY:	_____
DATE:	_____

A	MA	09-11-24	RELEASED PER PDR 20013-4	
	AB	09-03-21	CHANGED FROM 827-1PG-B TO 911-1PG; P-20013-4	
		06-04-21	CHANGED TO ALL SOLDER CUPS FACING DOWN	
		03-19-21	CREATED PER PDR 20013	
REV.	INIT.	DATE	DESCRIPTION	
ALL INFORMATION ILLUSTRATED IS THE PROPERTY OF "CONXALL CORPORATION". UNAUTHORIZED DUPLICATION OR DISTRIBUTION OF THIS DOCUMENT IS PROHIBITED.			ORIG. DRAWN BY: AB	DATE: 03-19-21
ALL UNITS ARE IN FEET, INCHES, FRACTION OF INCHES AND DECIMALS.			CHECKED BY:	 601 E. WILDWOOD VILLA PARK, IL 60181
			APPROVED BY:	
			SCALE: NTS	
			SIZE: B	
			SHEET: 1 OF 1	
			FILE: SAME AS P/N	
			DIRECTORY: SLW	
			PART NUMBER: W4B82-7PG-300	REV A

DIMENSIONS IN BRACKETS [] ARE METRIC.

RoHS COMPLIANT

CRITICAL CHARACTERISTIC FLAG PER SPEC. XXXX