

RECOMMENDED RG-316/U CABLE STRIP DIMENSIONS

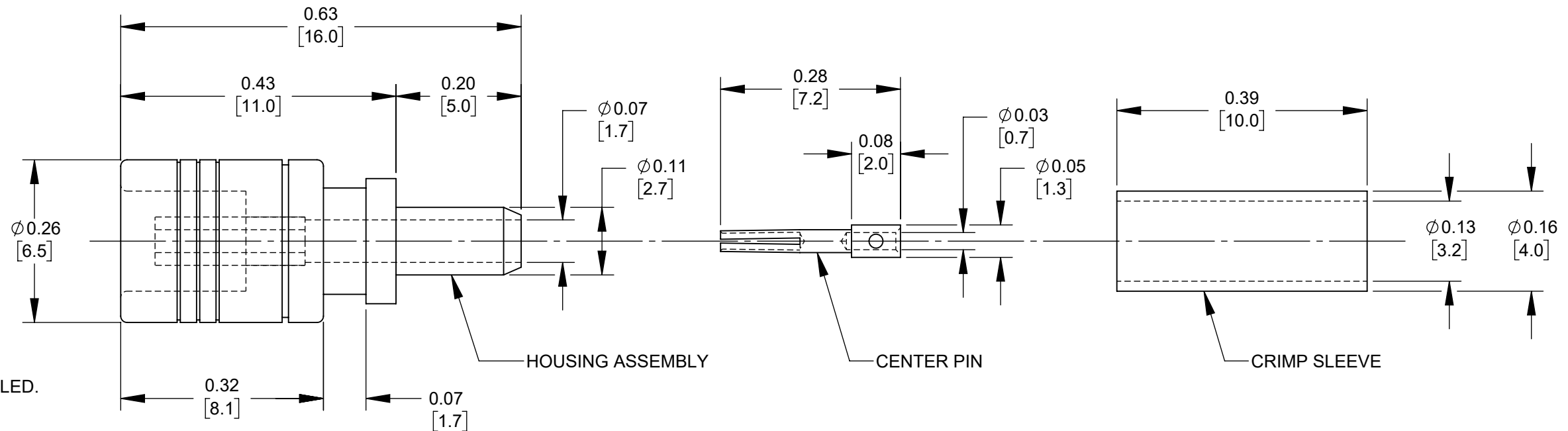
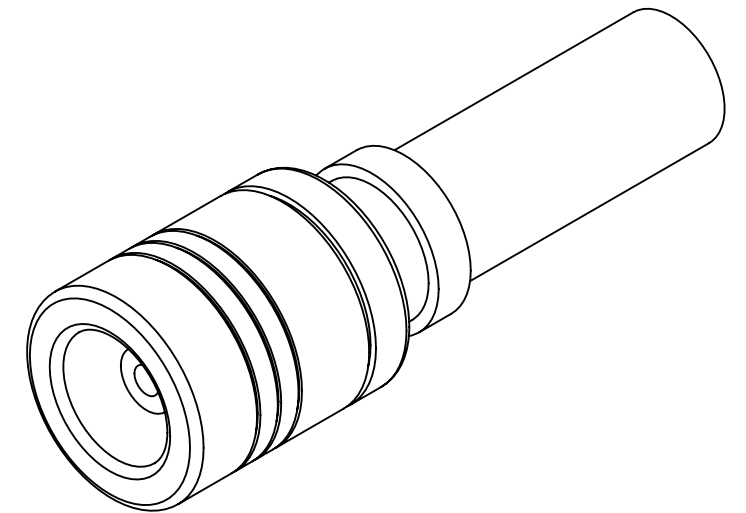

NOTES:

- PARTS ARE SUPPLIED UNASSEMBLED.
- MATERIAL:**
 HOUSING - BRASS (C3604), GOLD PLATED
 CENTER PIN, SPRING - BeCu, GOLD PLATED
 CRIMP SLEEVE - BRASS (C3604), NICKEL PLATED
 INSULATOR - TEFLON, WHITE
 SPRING WASHER - STAINLESS STEEL (SUS)
- WIRING INSTRUCTIONS:**
 INSERT CABLE THROUGH CRIMP SLEEVE,
 STRIP ONE END OF CABLE,
 SOLDER CONDUCTOR TO CONTACT PIN,
 PUSH PIN AND CABLE INTO CONNECTOR HOUSING,
 PULL CRIMP SLEEVE OVER BRAID TO REAR OF CONNECTOR,
 CRIMP SLEEVE WITH 0.135 (3.42mm) HEX
- THESE PARTS ARE RoHS COMPLIANT.

CUSTOMER DRAWING

					THIS DRAWING DESCRIBES A DESIGN CONSIDERED PROPRIETARY IN NATURE, DEVELOPED AND MANUFACTURED BY SWITCHCRAFT INC. AND IS RELEASED ON A CONFIDENTIAL BASIS FOR IDENTIFICATION PURPOSES ONLY.				
					SIZE	WIDTH	MULT	LBS/M	TEMPER
					FINISH			MATERIAL	
					SPEC No.			SPEC No.	
					FIRST USED ON		SCALE		
							5:1		
DATE DRAWN		BY	CHKD	APVD					
3-7-2024		SRC	SRC	SRC					
			3-7-2024	3-7-2024	SHEET 1 OF 1				
REV					NAME			PART No.	
ECO NUMBER					SMB SOCKET PLUG			SMB SRG316	
DATE					FOR RG316 CABLE, RoHS			REV	
BY					A				
APVD									
REVISIONS									

DO NOT SCALE DRAWING

SolidWorks CAD File